

COLBOR

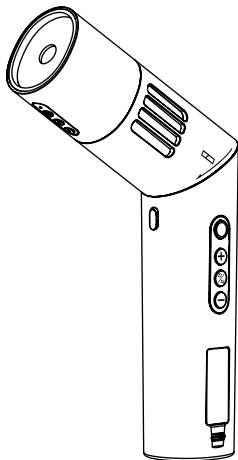

CineFlare CF5 Fog Machine

User Manual

Thank you for choosing COLBOR product. Please read this manual carefully before use and follow all instructions mentioned herein.

Caring For Your COLBOR Product

- Please keep the product in a dry, clean, dust-free environment.
- Keep corrosive chemicals, liquids, and heat sources away from the product to prevent mechanical damage.
- Use only a soft and dry cloth for cleaning the product.
- Malfunction may be caused by dropping, the impact of external force.
- Do not attempt to disassemble the product. Doing so voids the warranty.
- Please have the product checked or repaired by authorized technicians if any malfunctions happen.
- Please remove the USB charging cable when the battery is fully charged.
- The product might get hot during use, which is normal. Please allow a certain space for the heat sink when using it.
- If you do not use the product for a long time, it might not be able to turn on instantly due to the dead battery. Please charge the product and it can resume work. Please charge the product every 3 months regularly.
- Failure to follow all the instructions may result in mechanical damage.
- Warranty does not apply to human errors.

Product Instructions

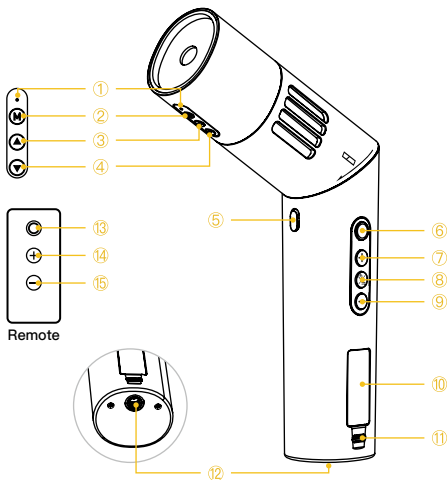

- | | | |
|------------------------|---------------------|-----------------------------------|
| ① Indicator | ⑥ Fog Output Button | ⑪ Type-C Charging Port |
| ② Button M | ⑦ Button + | ⑫ 1/4 Screw Hole |
| ③ Button ▲ | ⑧ Power Button | ⑬ Fog Output Button on the Remote |
| ④ Button ▼ | ⑨ Button - | ⑭ Button + on the Remote |
| ⑤ Rotation Lock Button | ⑩ Screen | ⑮ Button - on the Remote |

Operation Instructions

1. Charging

Please use the Type-C cable for charging
It supports the input power of PD20W.

2. Oil Juice Filling

Open the oil-filling cap, align the oil bottle with the port, and squeeze to fill. Close the cap after filling.

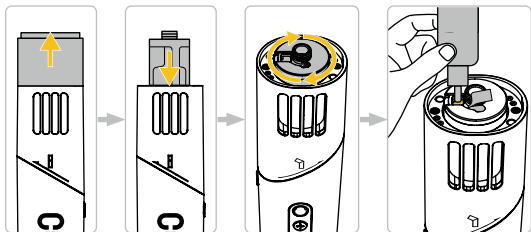

* For first-time use, please fill the chamber to over half and let it sit for 5 minutes before using.

* Please refill the chamber if the liquid level falls below 1/3.

* Please turn off the power when refilling.

* Before powering on, ensure the chamber is installed and securely tightened.

3. Body Rotating

Press down the rotation lock button and
turn the body. Release the button to lock.

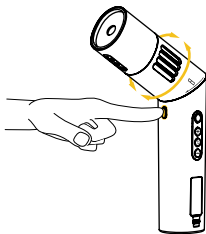

4. Power On/Off

Long press the power button for 3s to turn on/off.

It will auto-shut off after 5 minutes of inactivity.

5. Smoke Output/Stop Output

1. Long press the smoke output button to output the smoke, release to stop.

2. Continuously Output: Double-click the button to output the smoke continuously, double-click again to stop.

- ★ After 60 seconds of continuous smoke output, there will be a 10-second pause before the next smoke output.
- ★ CF5 will activate the overheat protection and stop outputting for 30 seconds after 5 minutes of continuous smoke output at Max. power (including 10-second pauses every 60 seconds). Please double press the smoke output button again to output the smoke.
- ★ Ensure the oil covers the chamber bottom when outputting the smoke to prevent dry burning.

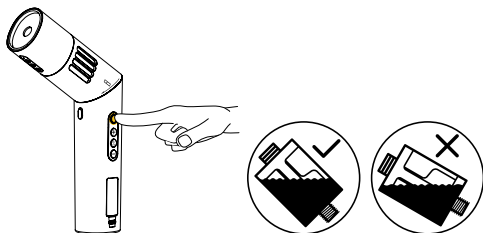

6. Smoke Parameter Adjustment

Short press the power button to cycle through options for density, output speed, and cycling parameters. The selected option will be highlighted.

6.1 Density

Select the density option, short press the +/- button to adjust (5 levels).

6.2 Output Speed

Select the output speed option, short press the +/- button to adjust (5 levels).

6.3 Output Cycling

Select the output cycling option, short press the +/- button to enter the output cycling settings page.

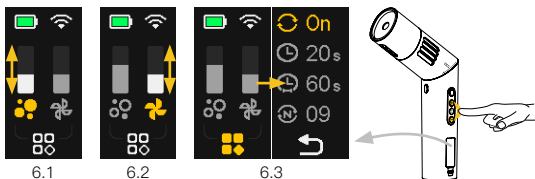

6.4 Settings

Short press the power button to cycle through options: cycle on/off, continuous output duration, output interval, and cycle times.

Press the +/- button to adjust the values, then short press the power button to confirm and move to the next option.

Short press the power button to select “”, then press +/- to exit.

① Cycle On/Off: On/Off

② Continuous Output Duration: 5s-10s-15s-20s-25s-30s-35s-40s-45s-50s-55s-60s

③ Output Interval: 5s-10s-15s-20s-25s-30s-35s-40s-45s-50s-55s-60s

④ Cycle times: 0-98 times

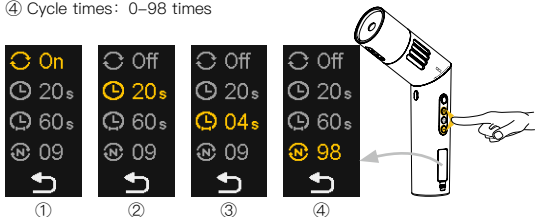

7. Fan Speed/RGB Light Adjustment

Attach the magnetic fan to the fog machine, press the M button to switch between RGB light mode/Fan mode.

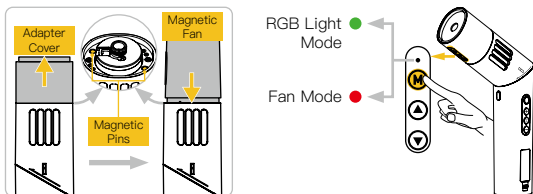

7.1 RGB Light Mode (Green Light):

Short press “▲”/“▼” to adjust brightness (3 levels).

Long press “▲” to select LED color, release to set the color.

7.2 Fan Mode (Red Light):

Short press “▲”/“▼” to adjust fan speed (3 levels).

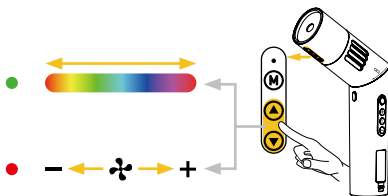

8. Remote Control

You can control multiple CF5 fog machines simultaneously within the remote's signal range.

8.1 Continuous Output/Stop Output

Short press the Fog Output button to start the smoke output. Short press again to stop.

8.2 Output Speed & Density Adjustment

Short press the +/- button to adjust the output speed and density simultaneously.

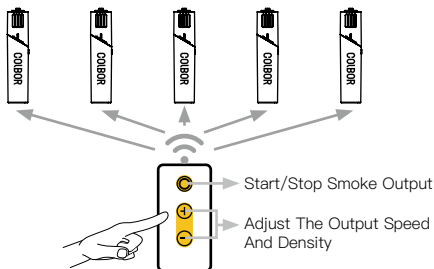

Packing List

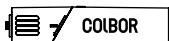

Fog Machine x1



Adapter Cover
x1



Chamber x1



Magnetic Fan &
RGB Light x1



Flexible Pipe x1



Bent Tube x2



Straight
Tube x1



Tube Adapter x1



Carrying Bag x1



Remote x1



Fog Juice
(60ml) x1



Type-C Charging
Cable x1



Open Cell
Foam x1



Warranty
Card x1

Specifications

Product	CF5
Size	231*48*42mm (Fog Machine) 51*48*42mm (Magnetic Fan)
Weight	351g (Fog Machine) 47g (Magnetic Fan)
Power	40W
Battery Capacity	2500mAh
Chamber Capacity	12ml
Runtime	Battery: 30min @ 100% Output Chamber(12mL): 15min @ 100% Output)
Charging Time	2H

WARRANTY

Warranty Period

Thank you for purchasing COLBOR products.

1. Customers are entitled to free replacement or repair service in case of quality defect(s) found in the product under normal use within 30 days upon receipt of the product.
2. Original COLBOR products are entitled to 12-month limited warranty service. The warranty period begins on the date of purchase of brand new, unused products by the first end-user.

Within the warranty period, if product defect or failure is attributable to material defection or technological problem, the defective product or defective part will be repaired or replaced without charge (service and materials fee).

Warranty Exclusions and Limitations

1. Faults resulted from inappropriate use of a product without following its operation specification
2. Artificial damage, e.g. crash, squeeze, scratch, soaking, exposing to rain or damp
3. Modifications to a product by its user or a third party without prior written consent of COLBOR, e.g. replacement of element or circuit, label alteration
4. The code on product is inconsistent with that of warranty certificate, or the code on the product or warranty certificate is altered or torn off
5. All consumable accessory attached to a product, like cable, cover
6. Faults as a result of force majeure, such as fire, flood, lightning, etc.

Warranty Claim Procedure

1. If failure or any problem occurs to your product after purchase, please contact a local agent for assistance, or you can always contact COLBOR's customer service through email.
2. Please retain your sales receipt and warranty certificate as proof of purchase. If any of these documents is missing, only sales return or chargeable service will be provided.
3. If the COLBOR product is out of the warranty coverage, the service and the parts cost will be charged.

Guangzhou Zhiying Technology Co., Ltd

 Room 2401, 24 / F, South Tower, Lisheng Plaza, No. 68 Huadi Avenue, Liwan District, Guangzhou, China, 510000

 support@colborlight.com

 www.colborlight.com